

GE Profile Fridge with Brita



- [Specifications](#)
- [Temperature Settings](#)
 - [Thermostat Position](#)
 - [Freezer Control](#)
 - [Refrigerator Control](#)
- [Freezing Evaporator Fan Design Flaw](#)
- [Parts](#)
 - [Cabinet](#)
- [Wiring](#)
- [References](#)

Specifications

Model: PDS18SBMRBS

Temperature Settings

Initially set the refrigerator and freezer controls at 5. For refrigerator and freezer, 5 is normal, 9 is coldest.

If you want colder or warmer temperatures, adjust the refrigerator temperature first. When satisfied with that setting, adjust the freezer temperature.

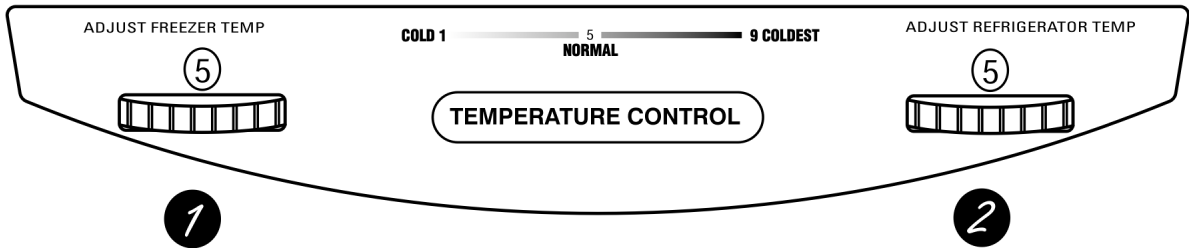

Thermostat Position

Fridge		Freezer		
Pos	Temp C	Pos	Temp C	Comment
0.1	13.0	3	-5.0	Never heard the fan come on.

0.2	8.4	7	-11.2	Fan is on.
1	7.7	9	-14.0	
1	7.5	3	-11.5	
5	5.0	5	-15	
7	3.7	5	-17.2	Ideal
7	3.8	7	-17.4	
9	3.2	9	-19.3	

Freezer Control

The freezer control maintains the temperature in the freezer compartment.

This is a mechanical switch which controls the a damper which regulates the flow of cold air into the refrigerator compartment.

Refrigerator Control

The refrigerator control maintains the temperature throughout the refrigerator compartment.

Moving the refrigerator control to OFF stops cooling in both areas---refrigerator and freezer---but does not shut off power to the refrigerator.

After changing the controls, allow 24 hours for the refrigerator to reach the temperature you have set.

This control is attached to the fridge thermostat.

Freezing Evaporator Fan Design Flaw

The drain has frozen over most-likely due to a design flaw in the GE fridges. The drain that you have de-iced drains into a snake-like line in the back of the fridge where it then drains into the evaporation tray in the bottom of the fridge. This snake-like drain line section is where the problem is, water builds up in here and freezes backing up your drainage system. This section is covered with a isolation-lined metal cover, by removing this cover this will prevent the line from freezing up and therefore eliminate the source of the problem. This does make the fridge slightly less energy efficient however the effects are not materialistic.

My fridge is not the same model and so my solution may not work if the structure is different. However, on my fridge on the back (outside) of the fridge there is a silver metal insulated cover that covers an S-shaped drain line, that is where my issue was.

Parts

Cabinet

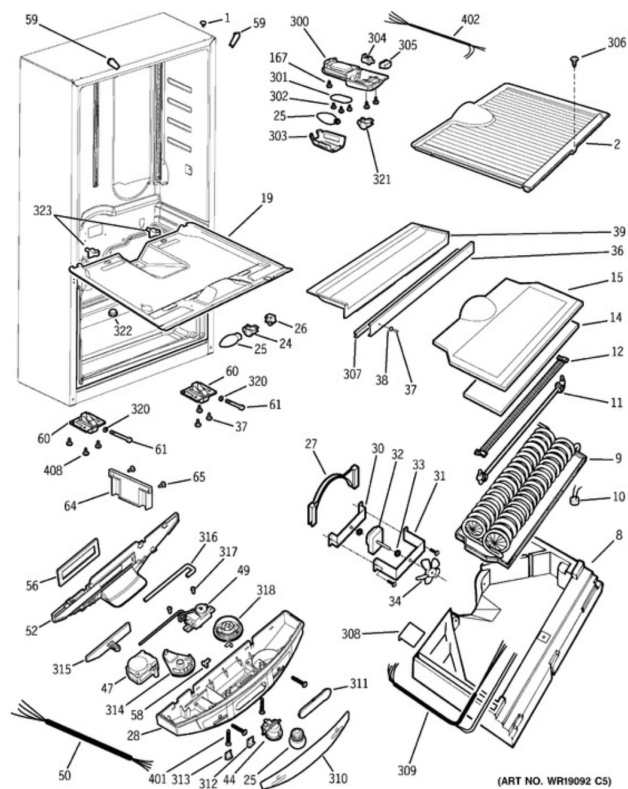

Item #	Description / Part #	Item #	Description / Part #
1	PLUG BUTTON BK CAB TOP	59	CAP, CORNER (BLACK)
2	BOTTOM (FZ)	60	MOBILITY, FRONT
8	PAN, EVAPORATOR DRAIN	61	SCREW
9	EVAPORATOR	64	ICEMAKER MOUNTING BLOCK WG03F00440 More Info
10	THERMOSTAT DEFROST	65	SCREW
11	HEATER, DEFROST	167	SCREW
12	STRAP, HEATER	300	HOUSING, CONTROL LIGHT
14	HEATER SHIELD EVAPORATOR	301	SHIELD, FRONT LIGHT
15	COVER, EVAPORATOR	302	SCREW (HI/LO PAN PHIL)
19	LINER, TOP (FZ)	303	COVER, LAMP
24	GE Refrigerator Socket & Terminal ASM WR01F01775 More Info	304	SWITCH LIGHT FF
25	LAMP (PURCHASE LOCALLY)	305	COVER, SWITCH
	LAMP (40W)(PURCH.LOCAL)	306	SCREW (WHITE)
	LAMP (15W)(PURCH.LOCAL)	307	THERMAL BREAK, MULLION
26	SWITCH LIGHT FZ	308	COVER, ELECTRICAL
27	BRIDGE EVAP HSGN	309	HARNESS, DIVIDER
28	HOUSING, CONTROL	310	OVERLAY, CONTROL HOUSING
30	BRACKET, FAN MOTOR(REAR)	311	LENS, CONTROL HOUSING
31	BRACKET, FAN MOTOR	312	PLUG, CNTRL HOUSING -RH
32	GE Refrigerator Evaporator Fan Motor WG03F02146 More Info	313	PLUG, CNTRL HOUSING -LH

References

Reference	URL
Manual	Dispatcher.pdf
Parts	https://www.reliableparts.ca/lookup/180523
Fixya Fix	https://www.fixya.com/support/t7165510-ge